

PLAN VIEW

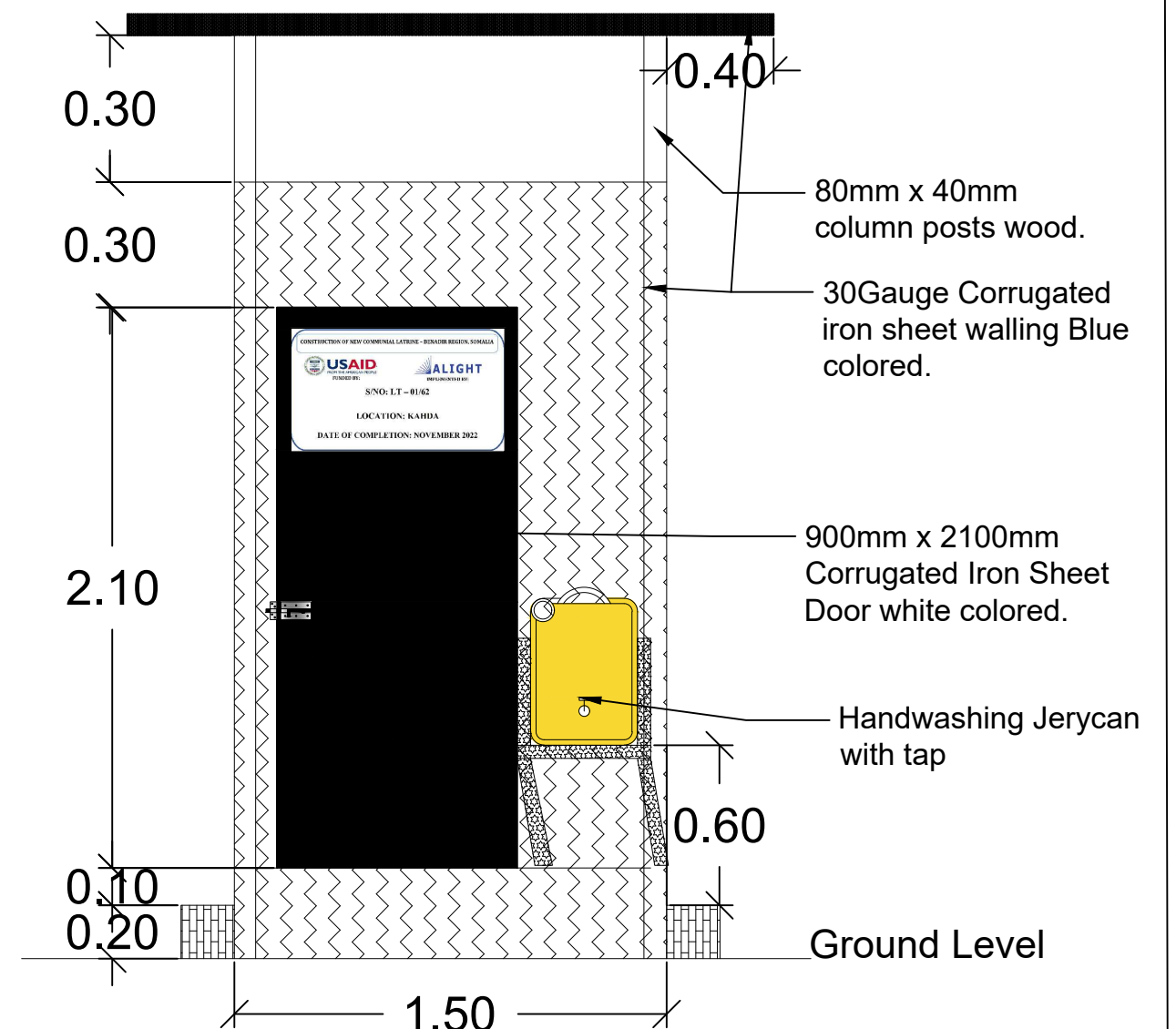

FRONT VIEW



ALIGHT

CAPITAL WEST 6TH FLOOR LANTANA
ROAD WESTLANDS NAIROBI

www.wearealight.org

PLAN AND FRONT VIEWS COMMUNAL LATRINE DESIGN

LOCATION: SOMALIA/SOMALILAND

DESIGNED BY: HASSAN M DAHIR

APPROVED BY: ADAN HALUBA

DRAWING NO:
NON-DISABLE -01

LAMINA NO.

1/2

DATE:

MARCH-2023

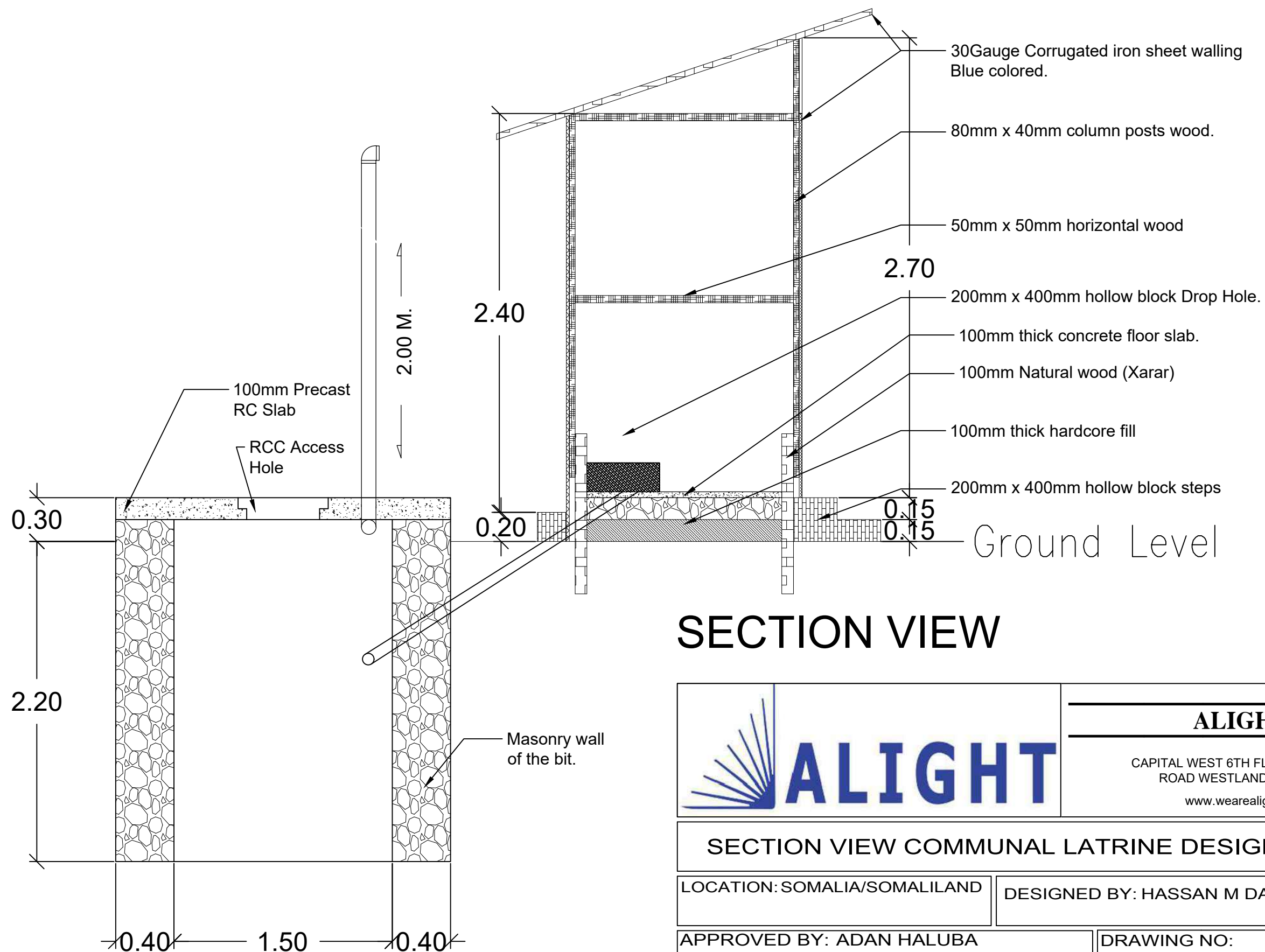

CAPITAL WEST 6TH FLOOR LANTANA
ROAD WESTLANDS NAIROBI
www.wearealight.org

LAMINA NO.

2/2

LOCATION: SOMALIA/SOMALILAND

DESIGNED BY: HASSAN M DAHIR

APPROVED BY: ADAN HALUBA

DRAWING NO:
NON-DISABLE -02

DATE:
MARCH-2023

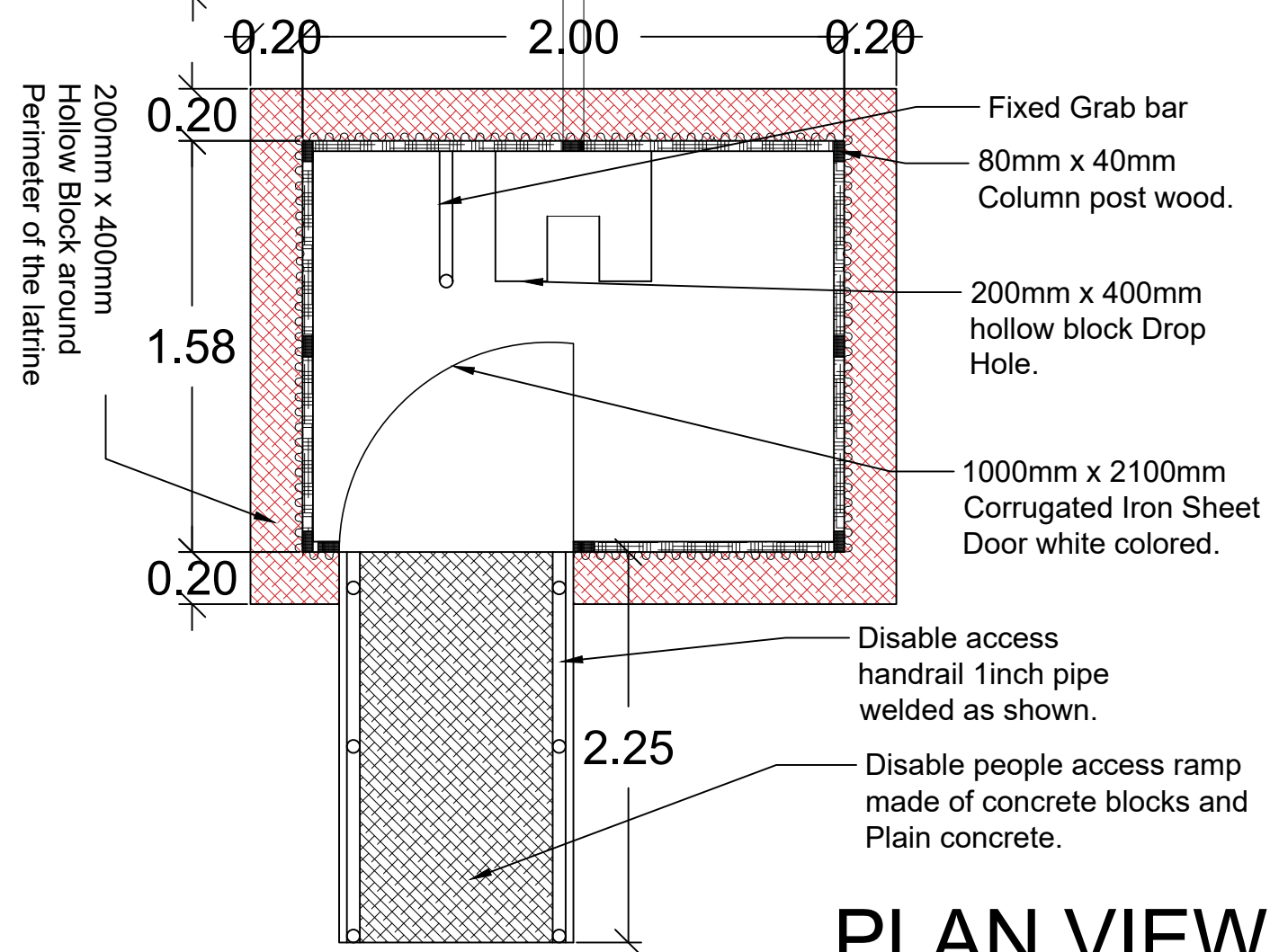
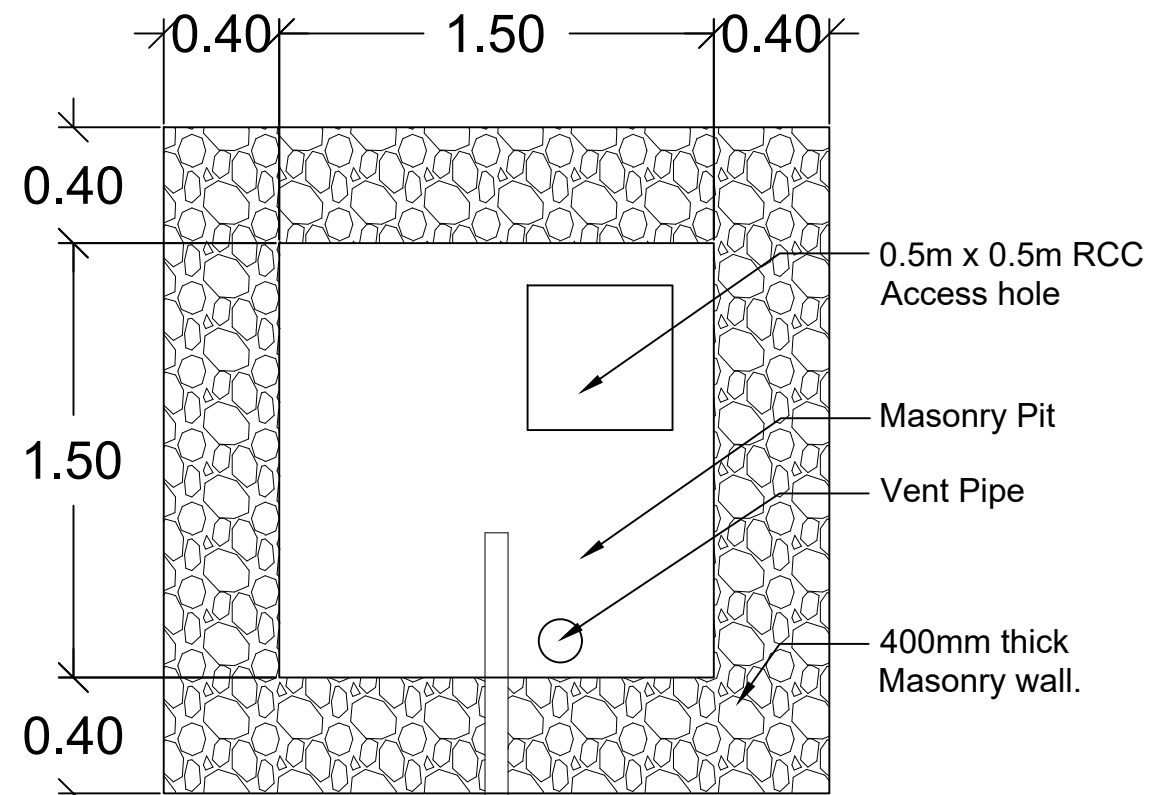

PLAN VIEW

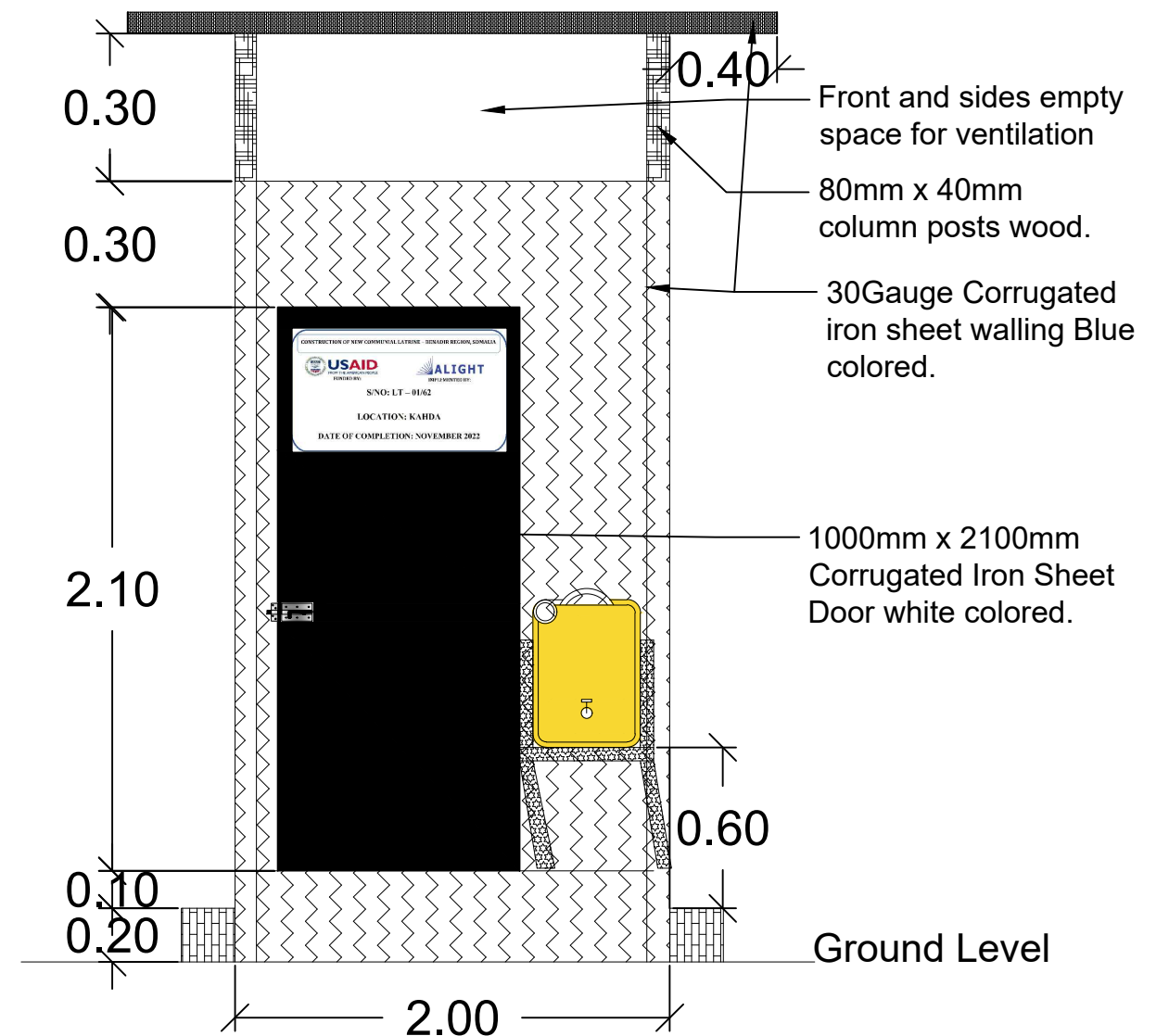

FRONT VIEW

		ALIGHT	
		CAPITAL WEST 6TH FLOOR LANTANA ROAD WESTLANDS NAIROBI www.wearealight.org	
PLAN AND FRONT VIEWS COMMUNAL LATRINE DESIGN			
LOCATION: SOMALIA/SOMALILAND		DESIGNED BY: HASSAN M DAHIR	
APPROVED BY: ADAN HALUBA		DRAWING NO: DISABLE LATRINE 01	LAMINA NO. 1/2 DATE: MARCH-2023

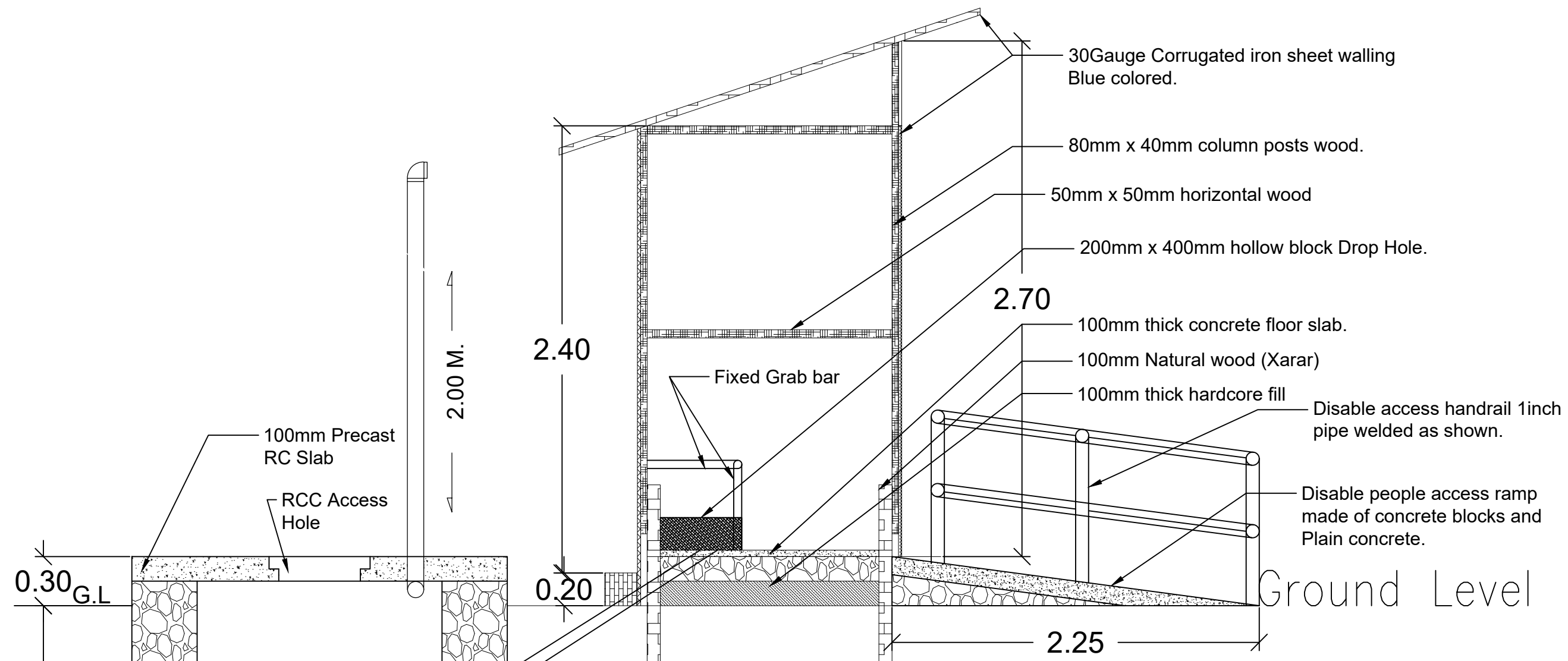

SECTION VIEW



ALIGHT

CAPITAL WEST 6TH FLOOR LANTANA
ROAD WESTLANDS NAIROBI
www.wearealight.org

SECTION VIEW COMMUNAL LATRINE DESIGN		SHEET NO: 2/2
LOCATION: SOMALIA/SOMALILAND	DESIGNED BY: HASSAN M DAHIR	
APPROVED BY: ADAN HALUBA	DRAWING NO: DISABLE LATRINE 02	DATE: MARCH-2023